



SYSTEMS

INSTALLATION INSTRUCTIONS - AK FIXED STOCK

Before beginning the installation process prioritize safety by ensuring the firearm is unloaded, the chamber is empty, the safety is engaged, and the firearm REMAINS pointed in a safe direction.

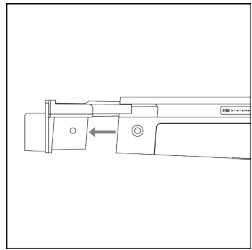
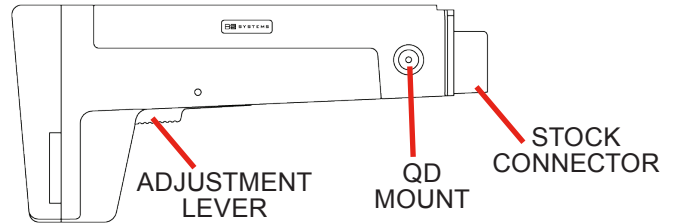

FIG 1

Slide the Stock Connector off the front of the stock.

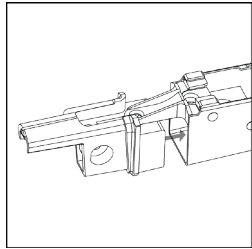

FIG 2

Insert the Stock Connector into the Receiver on the firearm, aligning with the Trunnion Tang.

*Due to the tolerance range of various manufacturers some fitment may be required.

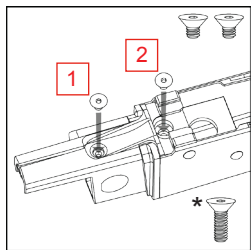

FIG 3

Using the 3/32" Hex Bit, install the (2) Flat Head 8-32 x 1/4" Hex Screws through the Trunnion Tang and into the Connector.

*For some models, the longer 8-32 x 1/2" screw is needed for use in position #2.

*Torque Screws to 4.5 in/lbs.

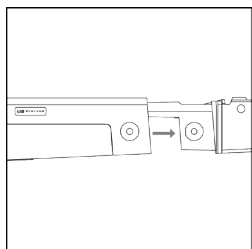

FIG 4

Once secure, slide the stock back onto the Stock Connector until flush.

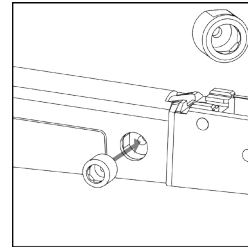

FIG 5

Place the QD Mount into the right side of the stock with the flat side going in first.

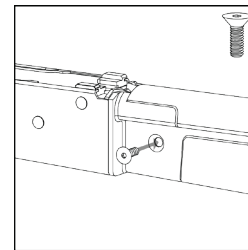

FIG 6

To secure the QD mount, use the 3/32" Hex Bit to install the Flat Head 8-32 x 1/2" screw through the left side of the stock. This will fasten into the back of the QD Mount.

*Torque Screw to 16.5 in/lbs.

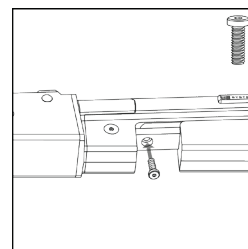

FIG 7

Open the stock using the Adjustment Lever. Using the 5/64" Hex Bit, install the 8-32 x 1/2" Socket Head Screw into the underside of the stock through the Adjustment Rail and into the Stock Connector.

*Torque Screw to 16.5 in/lbs.

Follow these step-by-step instructions for the removal and re-installation of Components, adhering to safety protocols throughout.

If necessary, carefully remove the existing stock in accordance with the manufacturer's recommendations, taking care to avoid any damage to the receiver.

Tools required - Torque Screwdriver with (1) 3/32" Hex Bit and (1) 5/64" Hex Bit

Materials Provided - Stock, Stock Connector, QD Mount, (2) 8-32 x 1/4" Flat Head Hex Screws, (2) 8-32 x 1/2" Flat Head Hex Screw, and (1) 8-32 x 1/2" Socket Head Screw

WARNING: Exceeding maximum torque limit may cause damage to the stock.

Confirming that the firearm remains clear, unloaded, and pointed in a safe direction perform a comprehensive function test.

For additional assistance or inquiries, please reach out to Customer Service at 937.372.4768